

Step Wall-mounted Longlight 5-25°

TECHNISCHE FICHE

Step Wall-mounted Longlight 5-25°

A Step solution consisting of multiple rows of VELUX Modular Skylights installed as Step Wall-mounted Longlight, where the modules are installed against a vertical wall in the top. The rows are installed close to each other using joint brackets and a clamping system that guarantee a fast and secure installation. The prefabricated flashings allows for configurations with a pitch of 5 to 25°.

The Wall-mounted Longlight Step solution is mounted on 100 mm wide standard steel profiles (not a VELUX component).

Please note that the same installation pitch is required on all rows and the maximum distance from the top of the vertical wall to the top of the lowest row of modules is 15 metres.

The supporting beams between the rows are not included in the VELUX delivery. The support structure must be designed by a structural engineer.

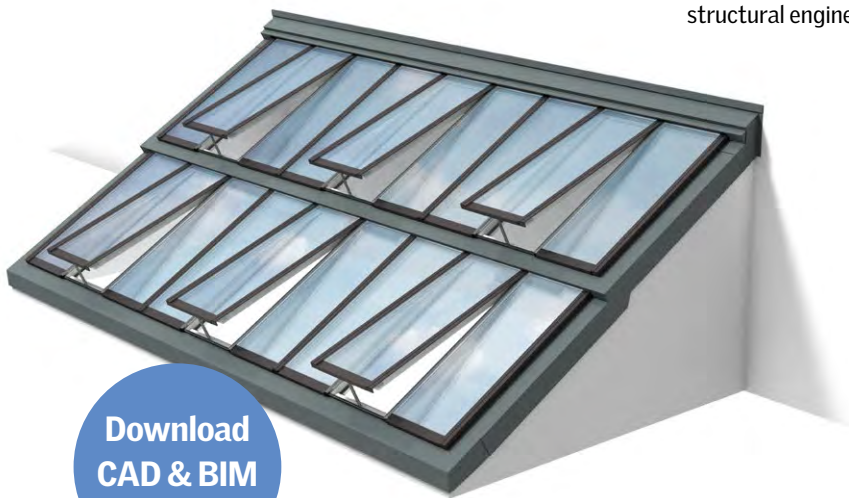

Download
CAD & BIM
objects



Sub-construction for
Step Wall-mounted Longlight 5-25°
veluxcommercial.com

Design your own grand ideas – Create a magnificent skylight

Ready to know if your ideas can become a reality?

Let us calculate your possibilities and give a price estimate for your chosen solution.

Contact your VELUX sales office for more details.



Step Wall-mounted Longlight 5-25°

TECHNISCHE FICHE

Solutions

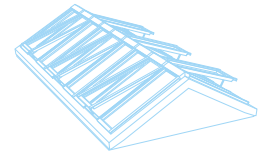

Sectional drawings

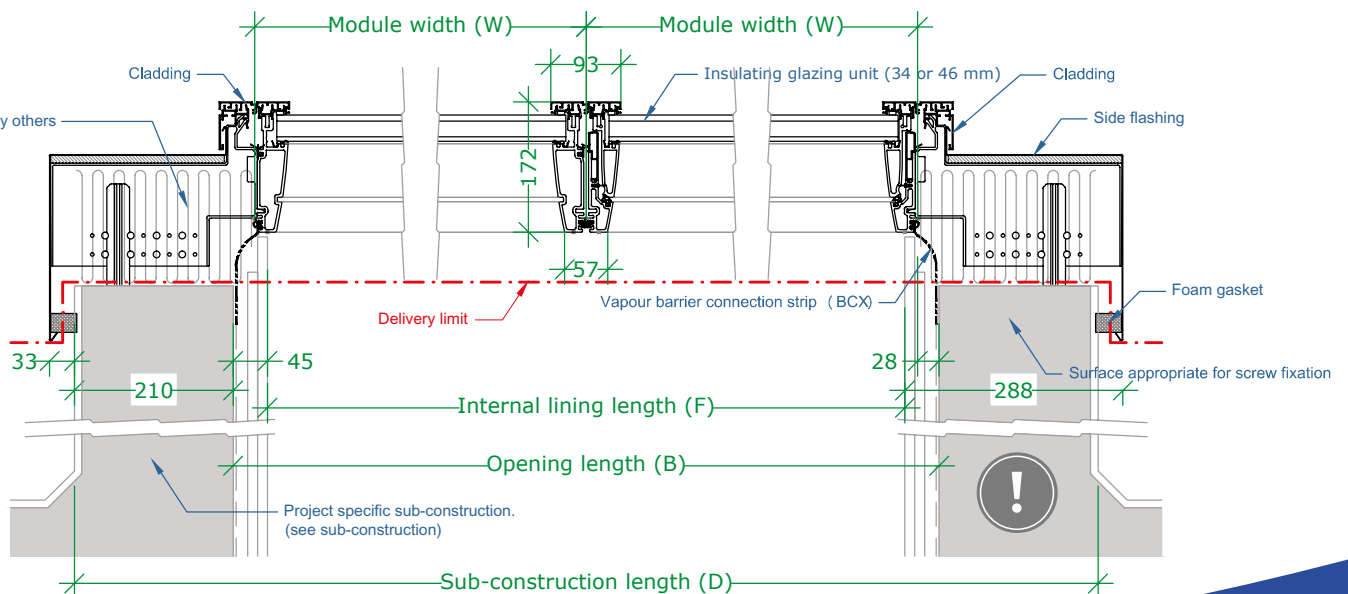
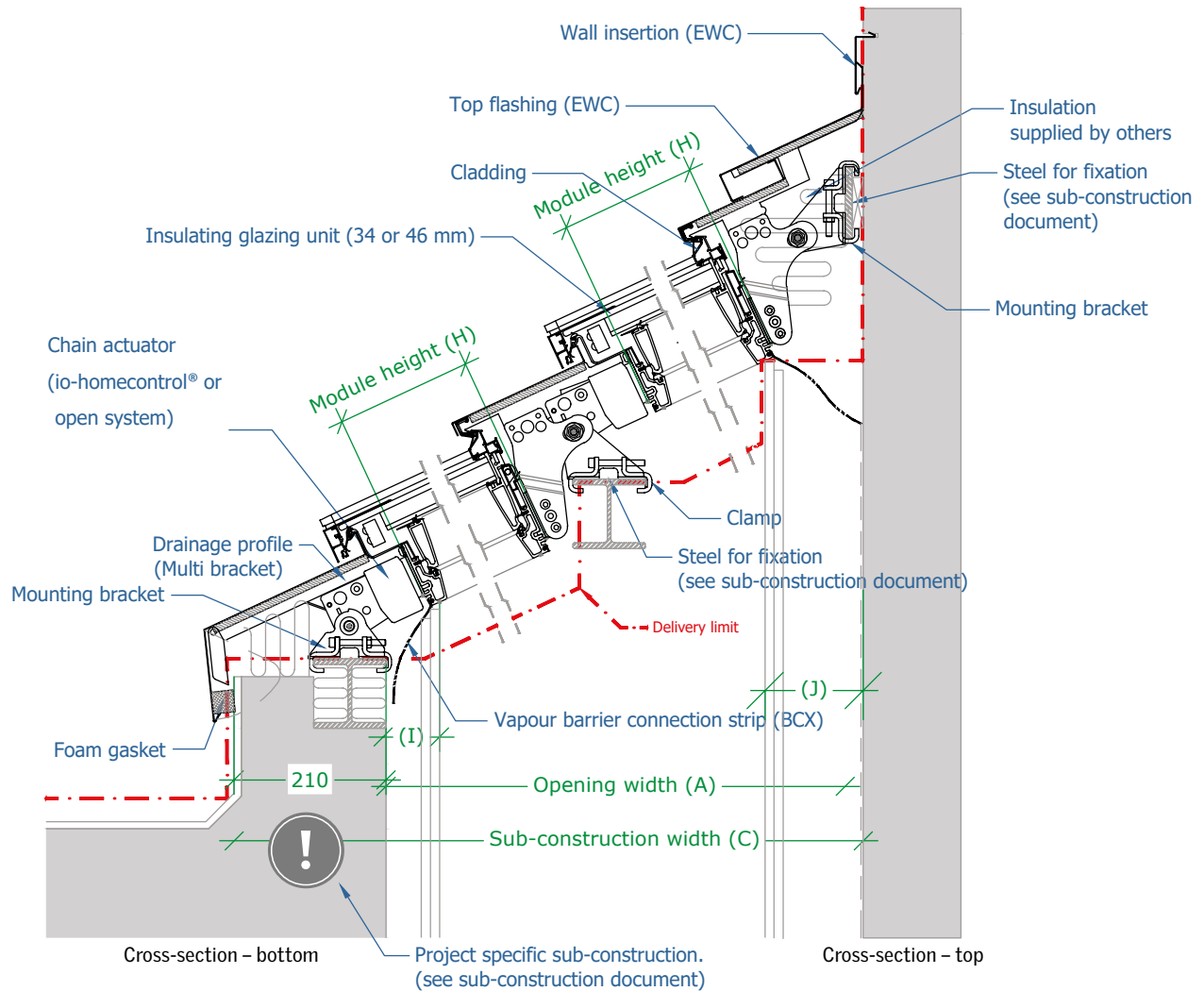

Please observe that a lateral slope on the modules is NOT possible, therefore top and bottom sub-construction must be horizontal.