

# Step Ridgelight 5-25° on Girder

TECHNISCHE FICHE

## Step Ridgelight 5-25° on Girder

A Step Ridgelight 5-25° on Girder, consist of a Ridgelight with one or more rows of modules below, on one or both sides, mounted close to each other using joint brackets and a clamping system that guarantee a fast and secure installation. The prefabricated flashing allows for configurations with a pitch of 5° or 25°.

The Step Ridgelight 5-25° on Girder solutions are mounted on 100 mm wide standard steel profiles (not a VELUX component).

Please note that the same installation pitch is required on all rows on the same side, however different installation pitches is possible on each side of the girder.

The maximum distance from the top of the lowest row of the modules to the top of total skylight is 15 metres.

The supporting beams between the rows are not included in the VELUX delivery. The support structure must be designed by a structural engineer.

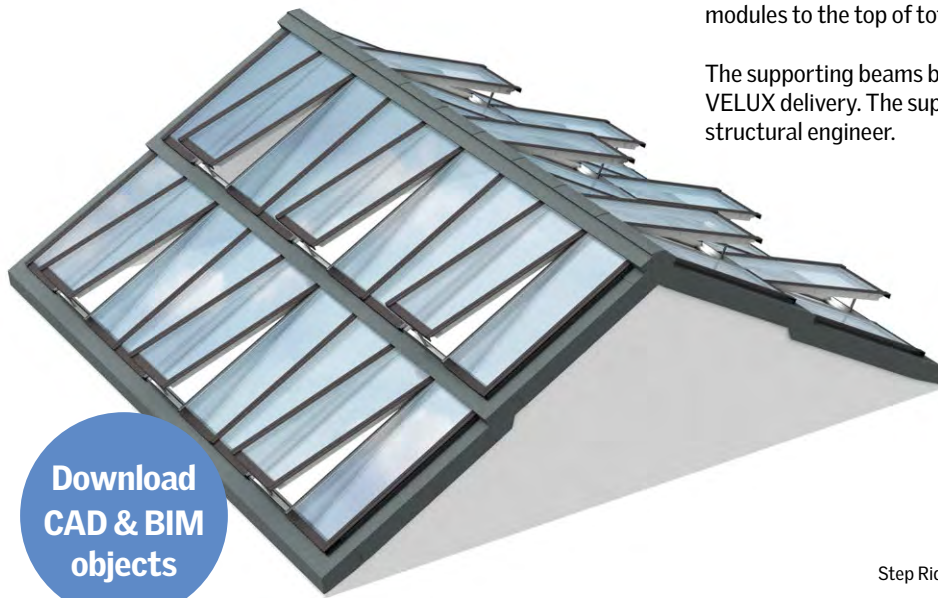

Download  
CAD & BIM  
objects

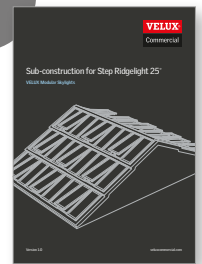

Sub-construction for  
Step Ridgelight 5-25° on Girder at:  
[veluxcommercial.com](http://veluxcommercial.com)

## Design your own grand ideas – Create a magnificent skylight

Ready to know if your ideas can become a reality?

Let us calculate your possibilities and give a price estimate for your chosen solution.

Contact your VELUX sales office for more details.



# Step Ridgelight 5-25° on Girder

TECHNISCHE FICHE

Solutions

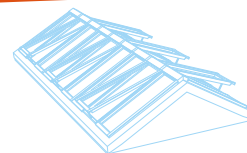

## Sectional drawings

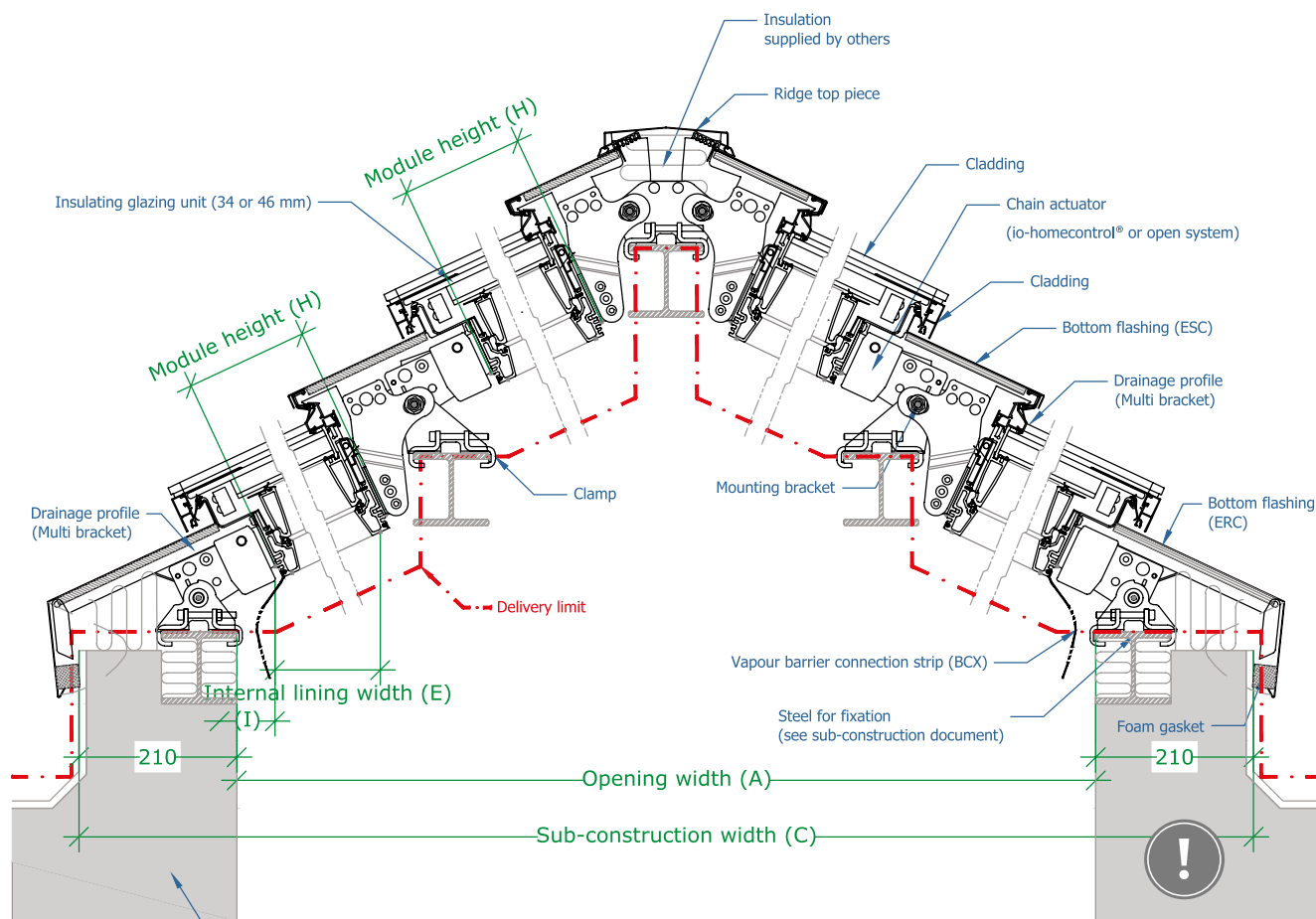

Cross-section - bottom

Cross-section - bottom

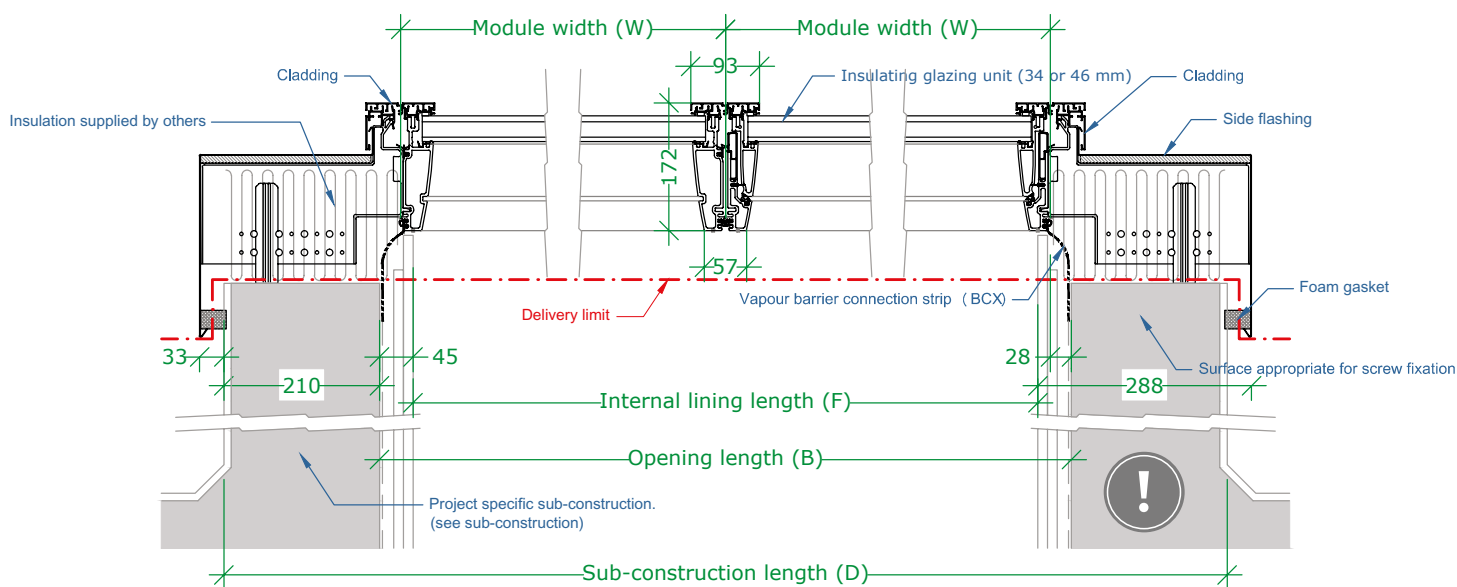

Longitudinal section

Please observe that a lateral slope on the modules is NOT possible, therefore top and bottom sub-construction must be horizontal.