

Step Ridgelight 25°

TECHNISCHE FICHE

Step Ridgelight 25°

A Step Ridgelight 25° consist of a Ridgelight with one or more rows of modules below, on one or both sides, mounted close to each other using joint brackets and a clamping system that guarantee a fast and secure installation. The prefabricated flashing allows for configurations with a pitch of 25°

The Ridgelight Step solution is mounted on 100 mm wide standard steel profiles (not a VELUX component).

Please note that the same installation pitch is required on all rows and that the maximum distance from the top of the lowest row of the modules to the top of total skylight is 15 metres.

The supporting beams between the rows are not included in the VELUX delivery. The support structure must be designed by a structural engineer.

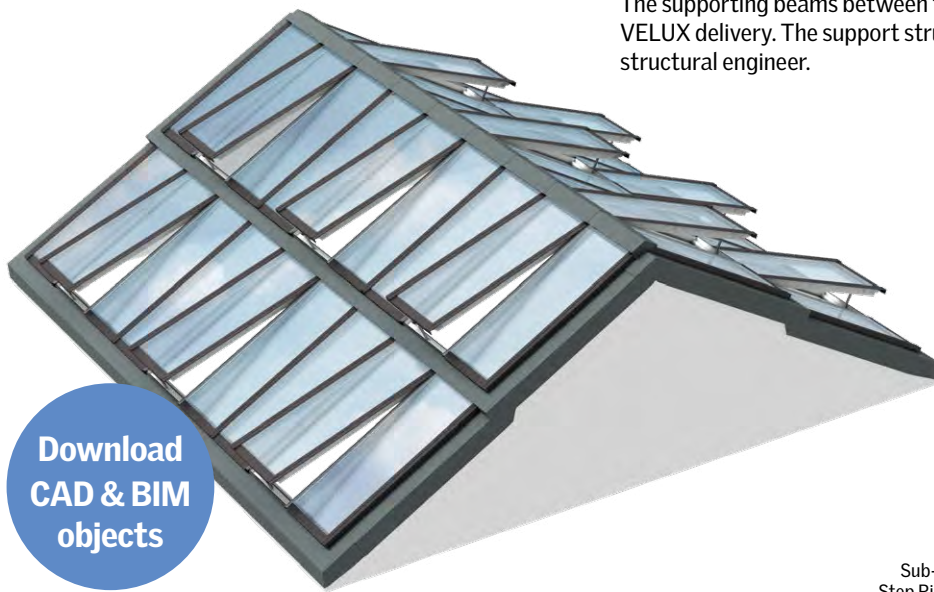

Download
CAD & BIM
objects



Sub-construction for
Step Ridgelight at 5° at:
veluxcommercial.com

Design your own grand ideas – Create a magnificent skylight

Ready to know if your ideas can become a reality?

Let us calculate your possibilities and give a price estimate for your chosen solution.

Contact your VELUX sales office for more details.



Step Ridgelight 25°

TECHNISCHE FICHE

Solutions

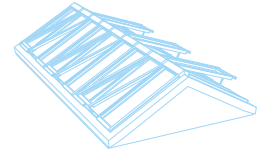

Sectional drawings

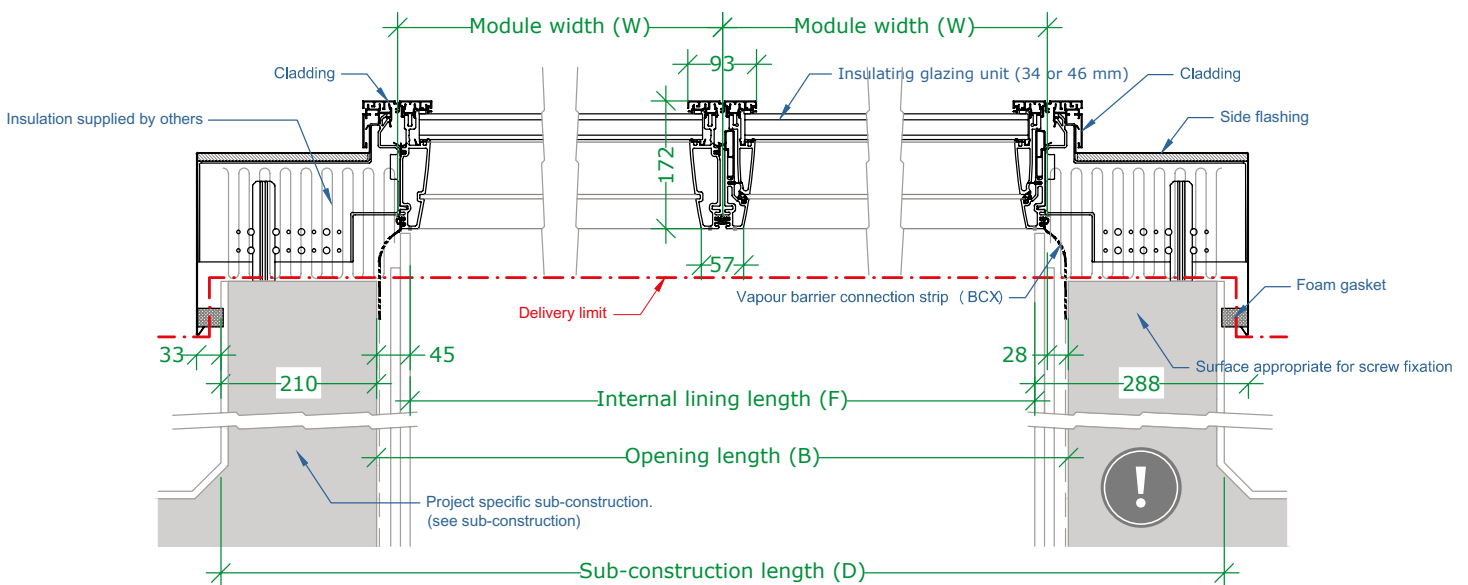
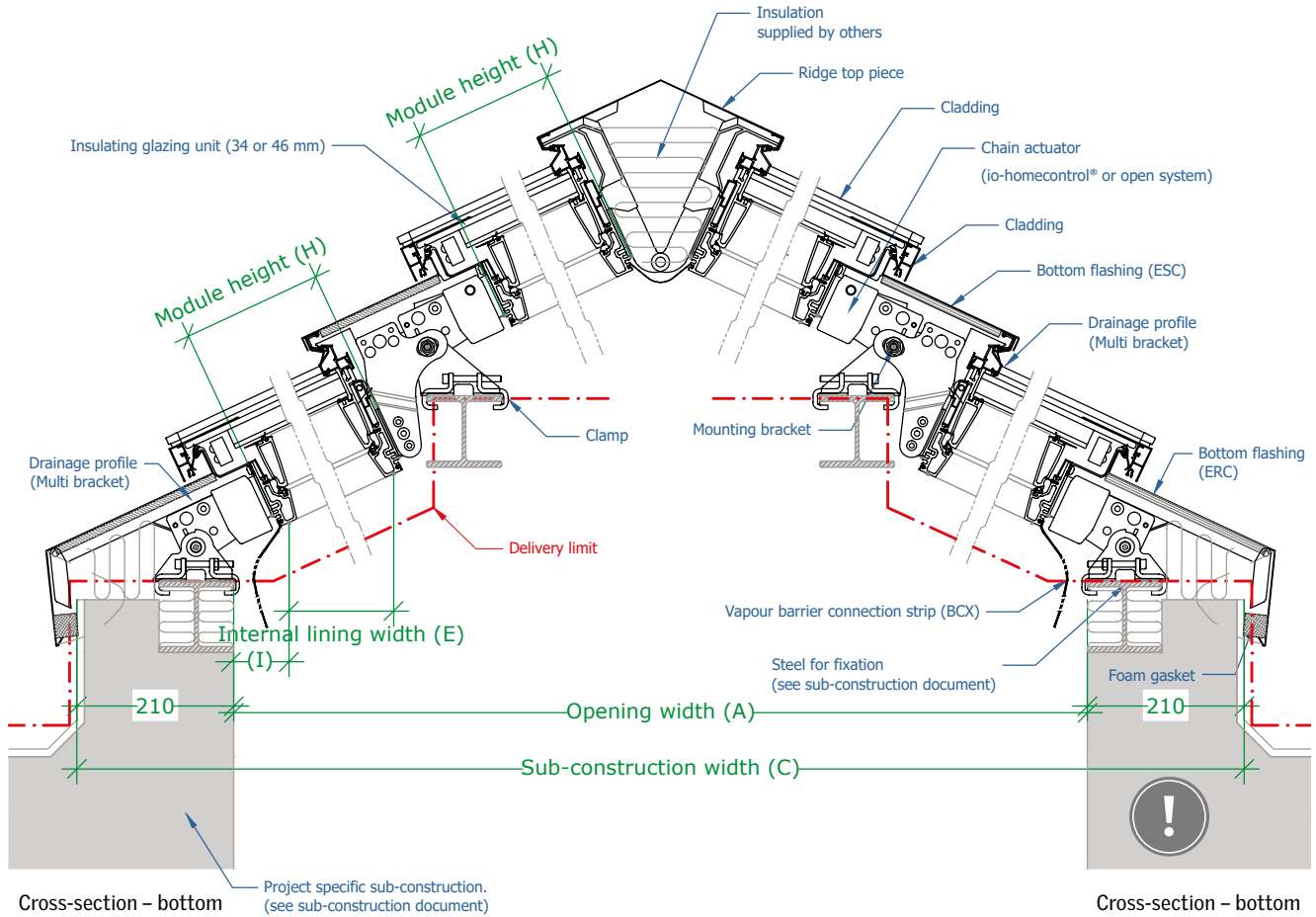

Longitudinal section

Please observe that a lateral slope on the modules is NOT possible, therefore top and bottom sub-construction must be horizontal.