

Step Longlight 5-25°

TECHNISCHE FICHE

Step Longlight 5-25°

Longlights in a Step solution are multiple rows of VELUX Modular Skylights installed close to each other using joint brackets and a clamping system that guarantee a fast and secure installation. The prefabricated flashing allows for configurations with a pitch of 5 to 25°.

The Longlight Step solution is mounted on 100 mm wide standard steel profiles (not a VELUX component).

Please note that the same installation pitch is required on all rows and that the maximum distance from the top of the lowest row of the modules to the top of total skylight is 15 metres.

The supporting beams between the rows are not included in the VELUX delivery. The support structure must be designed by a structural engineer.

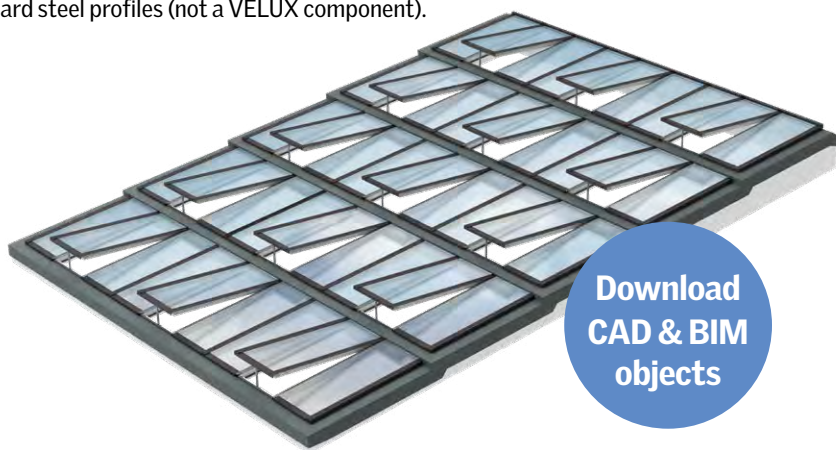

Download
CAD & BIM
objects



Sub-construction for
Step Longlight 5-25° at:
veluxcommercial.com

Use the table to define module height (H) and/or installation pitch (α).

Example:
A = 7000 mm

Result:
 $\alpha 1$: H = 3 rows x 2200 mm at an installation pitch of 8.5°
or
 $\alpha 2$: H = 3 rows x 2400 mm at an installation pitch of 23.5°

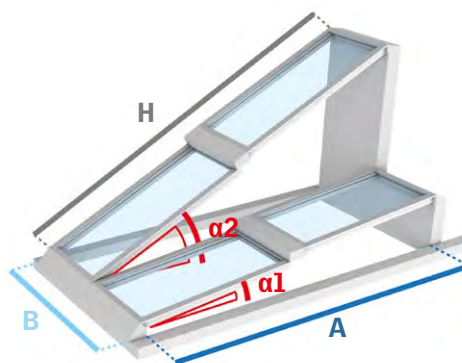

H: Module height
 α : Installation pitch
A: Opening width
B: Opening length

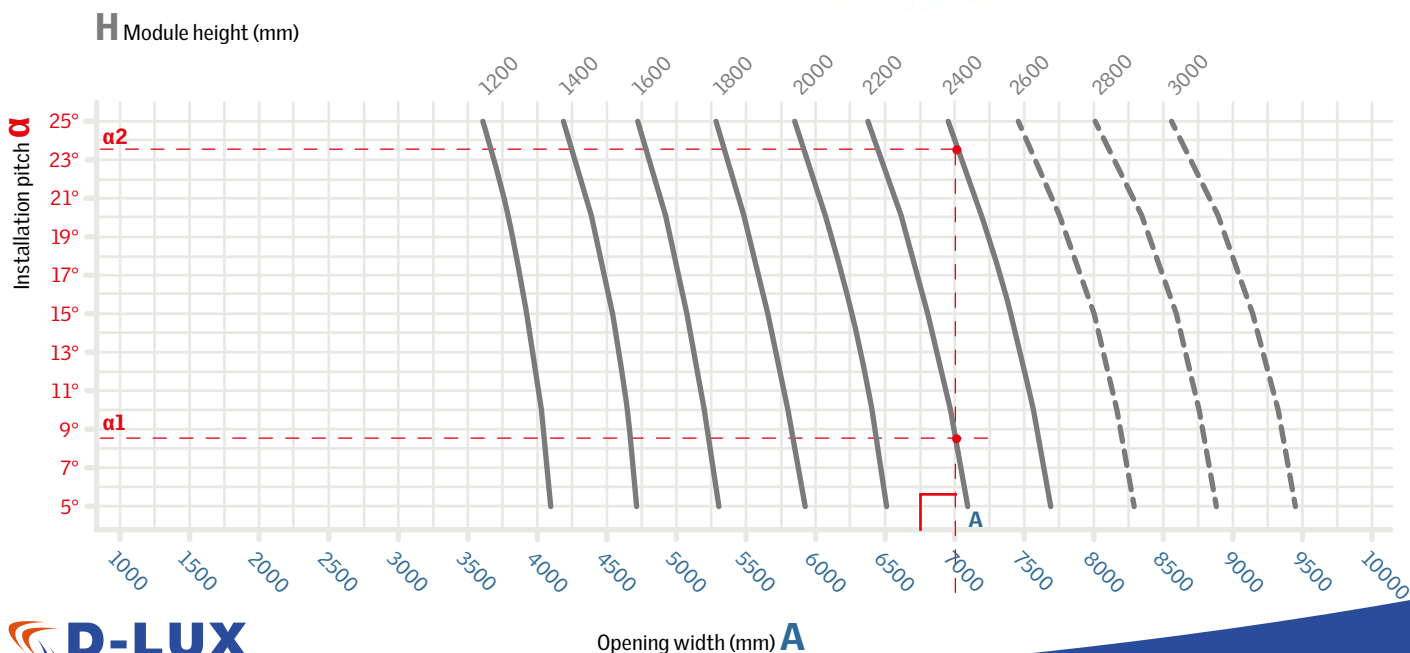

Step Longlight 5-25°

TECHNISCHE FICHE

Solutions

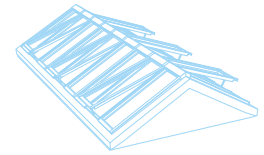

Sectional drawings

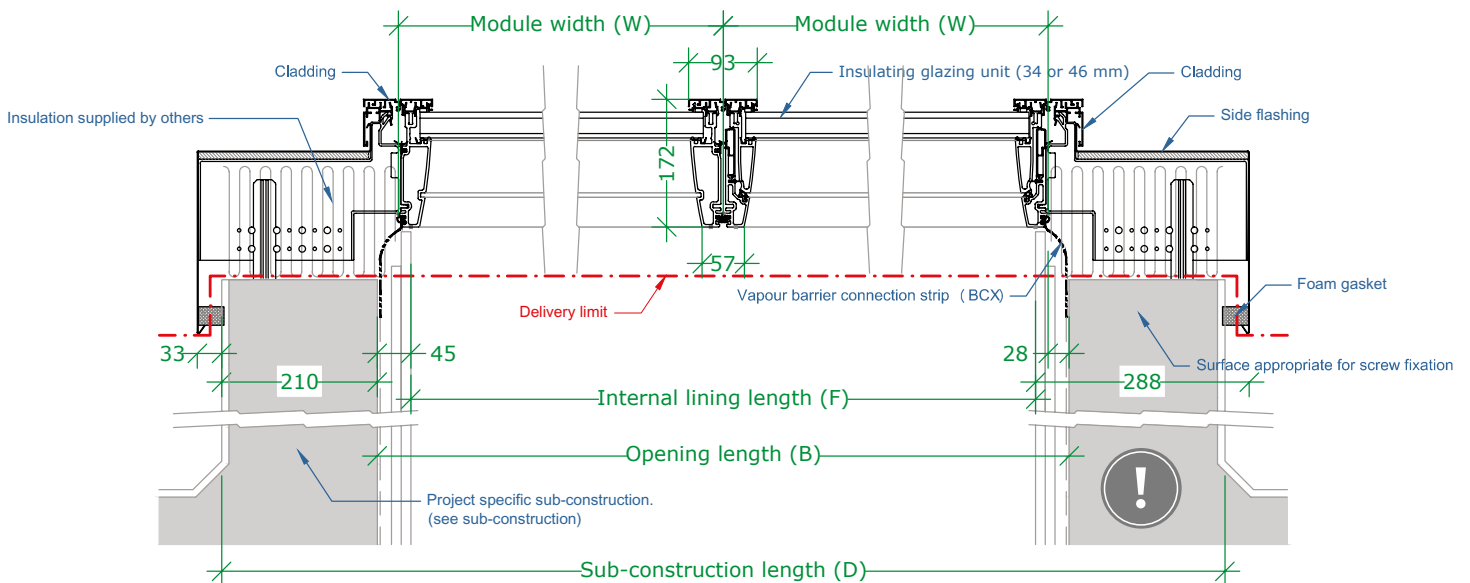
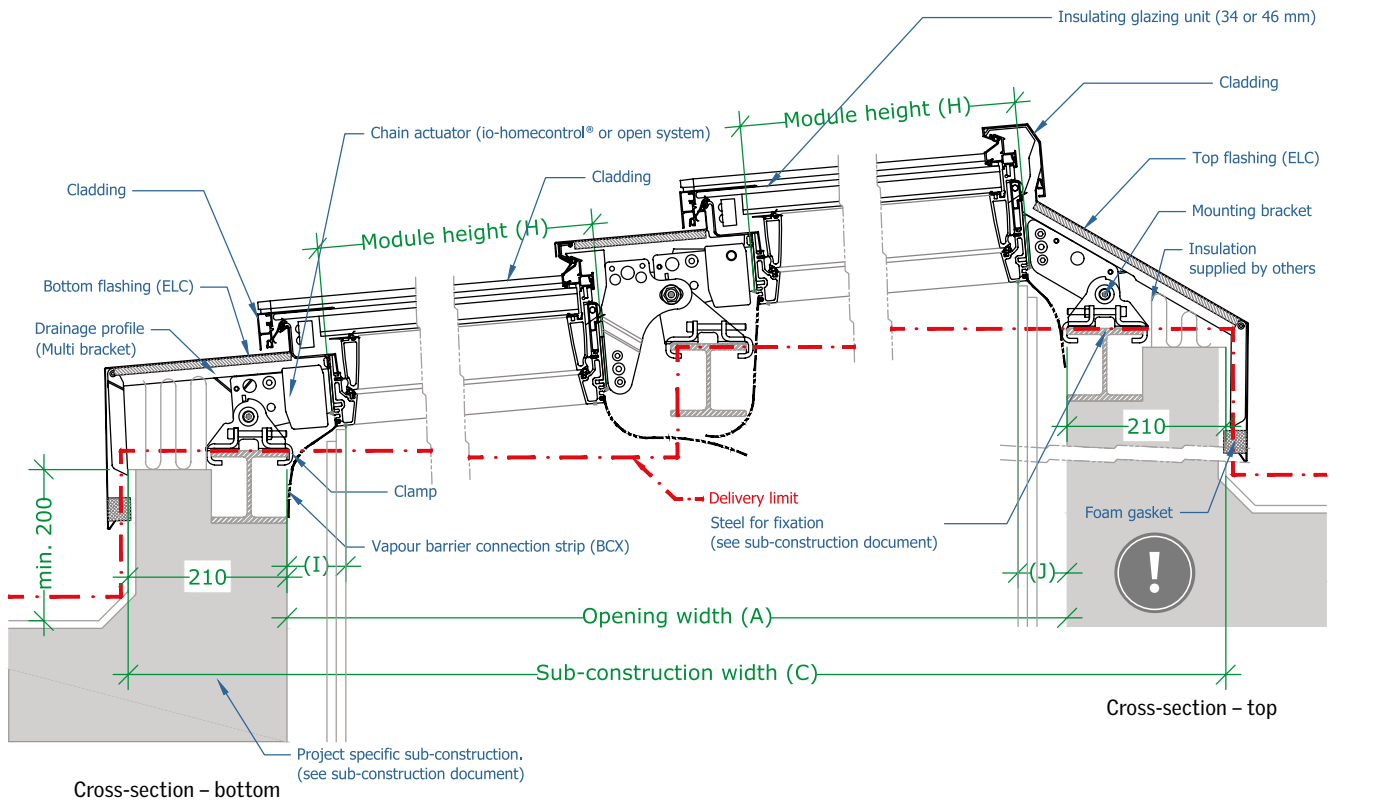

Please observe that a lateral slope on the modules is NOT possible, therefore top and bottom sub-construction must be horizontal.