

# Northlight 25-90°

TECHNISCHE FICHE

## Northlight 25-90°

Similar to Longlights, Northlights are bands of VELUX Modular Skylights. The characteristic upright design is primarily for installations that are directed towards the northern hemisphere for soft and reflected lighting. Northlight installations are applicable for a pitch of 25 to 90°.

At the bottom, Northlights are mounted on a standard steel profile, 100 mm wide (not a VELUX component) and fixed with clamps holding the skylight in place. At the top, the brackets are fixed to the sub-construction with screws meant for wood.

The prefabricated modular flashing ensures easy integration in the roof surface. All flashings are easily installed. The roof surface underneath the flashing must be appropriate for screw fixation.

Please observe a max. 10 m wall height above skylight module, when installed in a sloped roof. Take notice that the top flashing changes in size above and below 54°, see sectional drawing page 59.



Download  
CAD & BIM  
objects

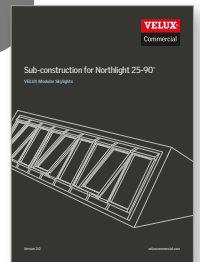

Sub-construction for  
Northlight at:  
[veluxcommercial.com](http://veluxcommercial.com)

### Defining module size to your project

Example:

$\alpha_1$ : H = 1600 mm at an installation pitch of 50°

$A_{max}$  = 1680 mm  
 $A_{min}$  = 1566 mm

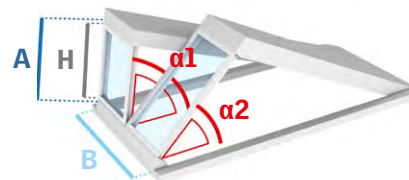

- H: Module height
- $\alpha$ : Installation pitch
- A: Opening width
- B: Opening length

Installation pitch  $\alpha$

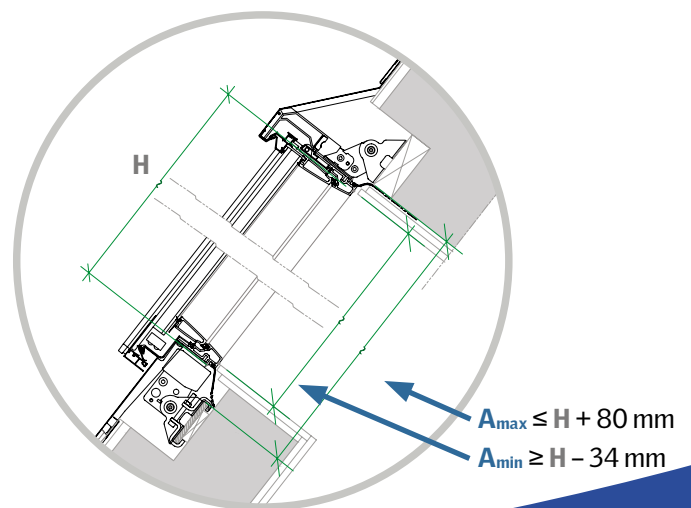
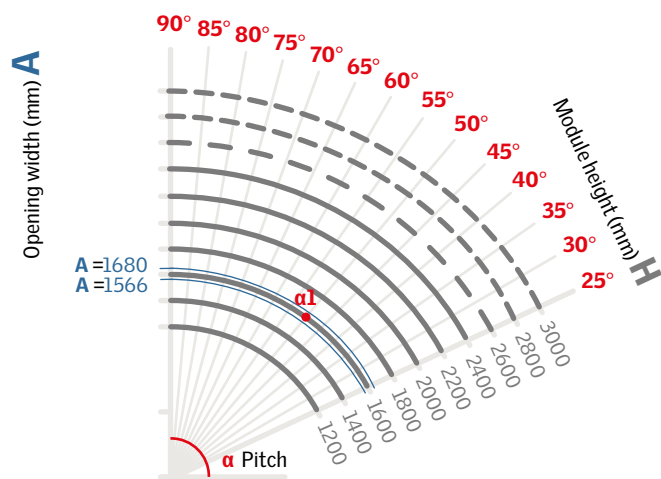

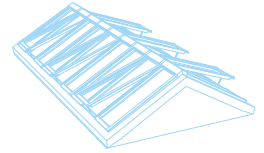

### Sectional drawings

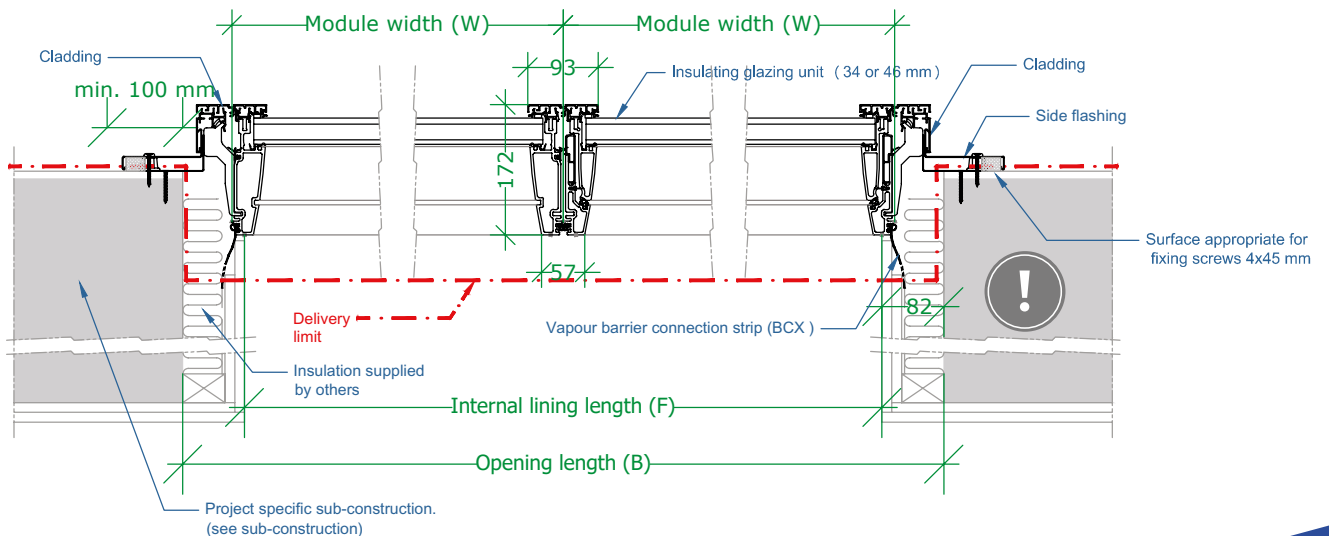
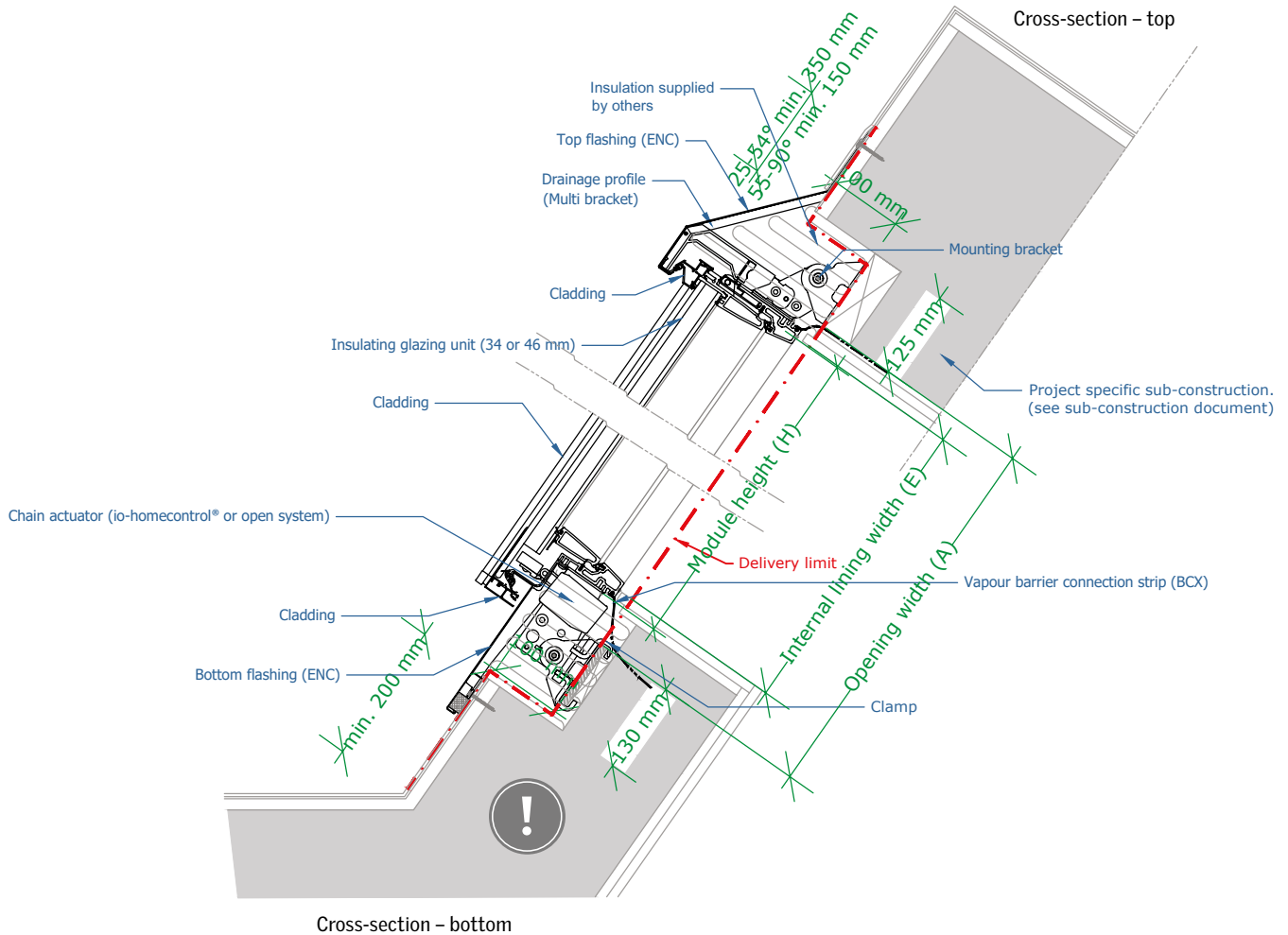

Please observe that a lateral slope on the modules is NOT possible, therefore top and bottom sub-construction must be horizontal.