

Atrium Longlight

TECHNISCHE FICHE

Atrium Longlight

An Atrium solution consists of several Longlights attached to each other in the sub-construction. A drainage gutter separates each assembly.

The supporting beams are not included in the VELUX delivery. The support structure is part of the primary structure of the building and will have to be designed by a structural engineer.

The distance between the skylights depends on thickness of insulation, width of drainage gutter and pitch of skylights. The shown example of an Atrium is designed with 100 mm insulation and a 400 mm wide drainage gutter in a 5° pitch, resulting in a distance between skylights of 820 mm.

Download
CAD & BIM
objects

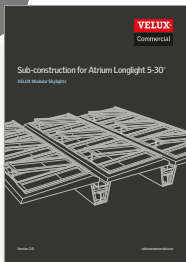

Sub-construction for Atrium Longlight at:
veluxcommercial.com

Use the table to define module height (H) and/or installation pitch (α).

Example:
A = 2870 mm

Result:
 $\alpha 1$: H = 2800 mm at an installation pitch of 10°
or
 $\alpha 2$: H = 3000 mm at an installation pitch of 23°

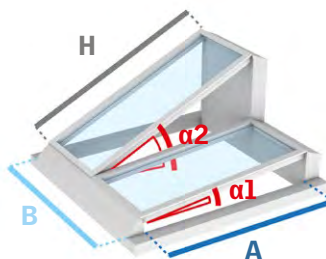

H: Module height
 α : Installation pitch
A: Opening width
B: Opening length

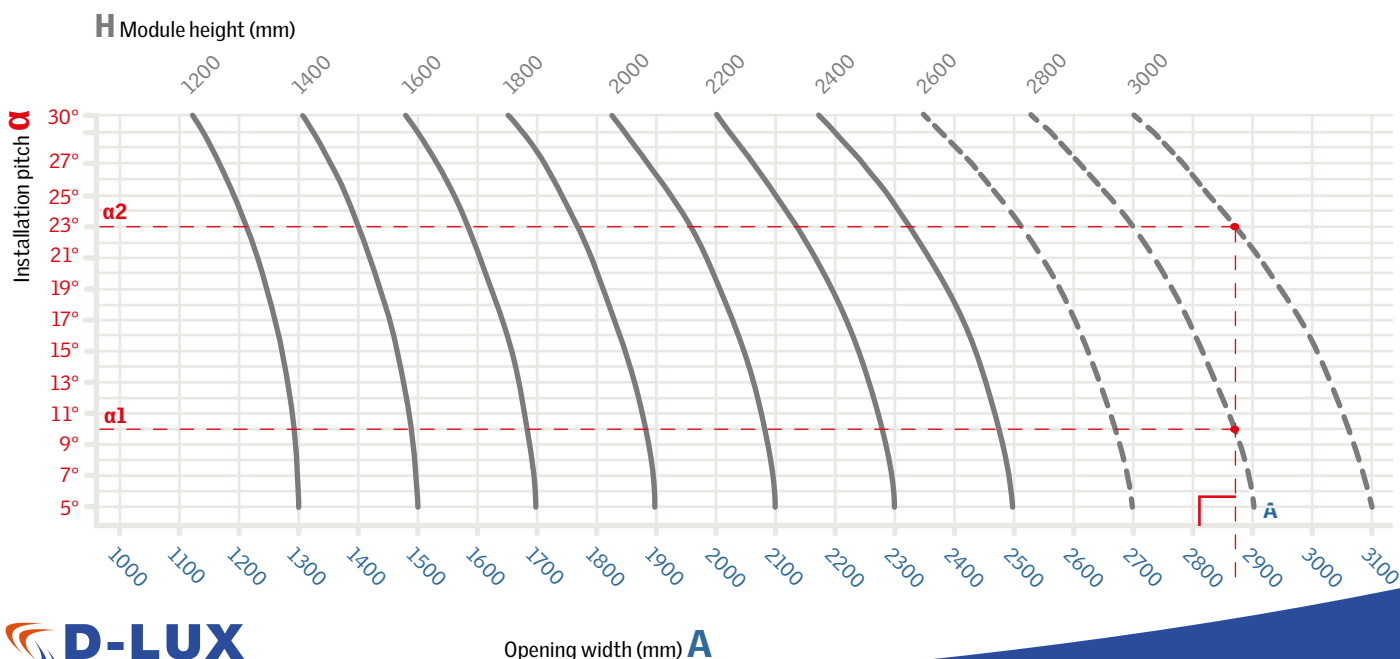

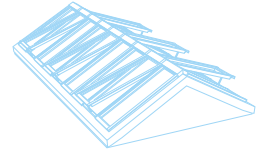

Sectional drawings

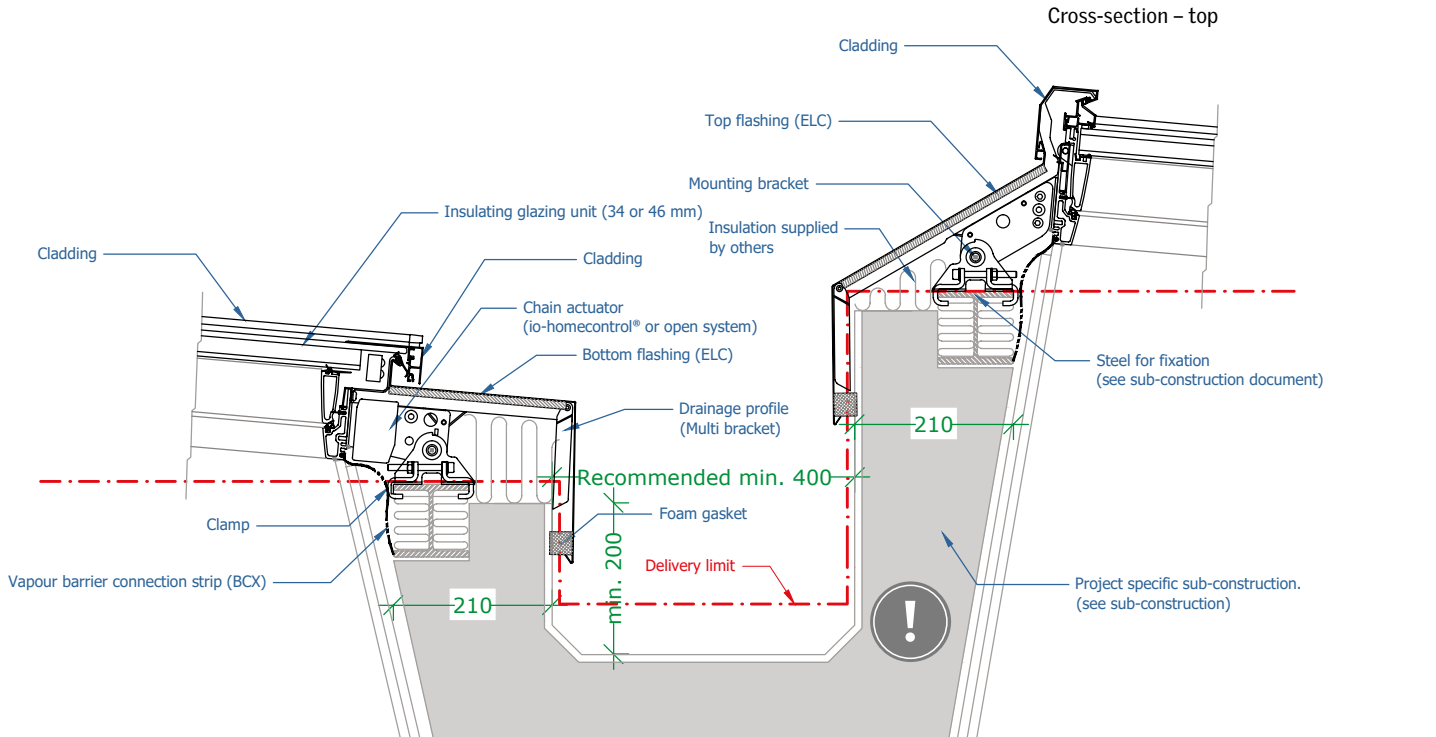

Cross-section - bottom

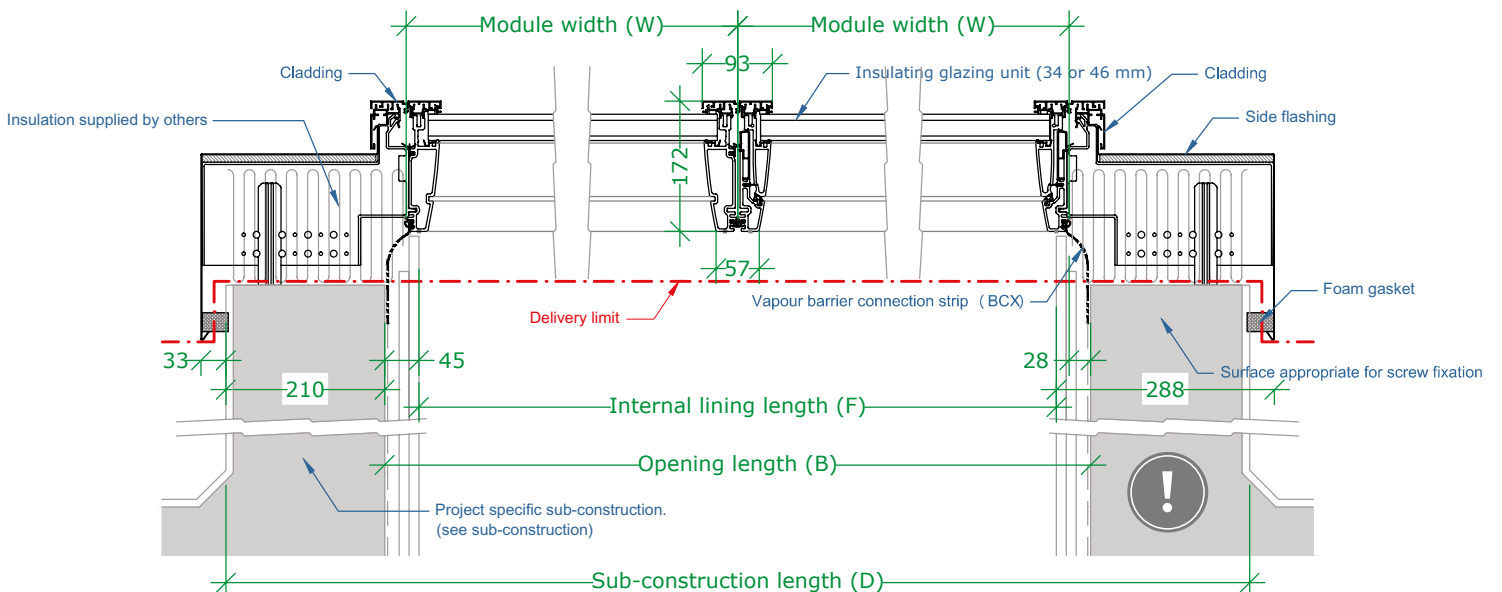

Please observe that a lateral slope on the modules is NOT possible, therefore top and bottom sub-construction must be horizontal.